

Contour hand control

OPERATION GUIDE



Lifestyle
BY A.H. BEARD™

CONTENTS

Contour Function	4
Power Down Box Operation	5
Contour Programming (<i>1 hand control - 1 bed</i>).....	6
Contour Programming (<i>2 hand controls - 1 bed</i>).....	7
Contour Programming (<i>1 hand control - 2 beds</i>).....	8
Contour Programming (<i>2 hand controls - 2 beds</i>).....	9
Contour Reprogramming (<i>separating 2 beds</i>).....	10

CONTOUR FUNCTION

IMPORTANT INFORMATION

READ ADVISORY INFORMATION IN THE OWNERS MANUAL CAREFULLY BEFORE USING THIS PRODUCT. THE POTENTIAL FOR ELECTRICAL SHOCK EXISTS IF ELECTRICAL COMPONENTS ARE NOT INSTALLED OR OPERATED PROPERLY.

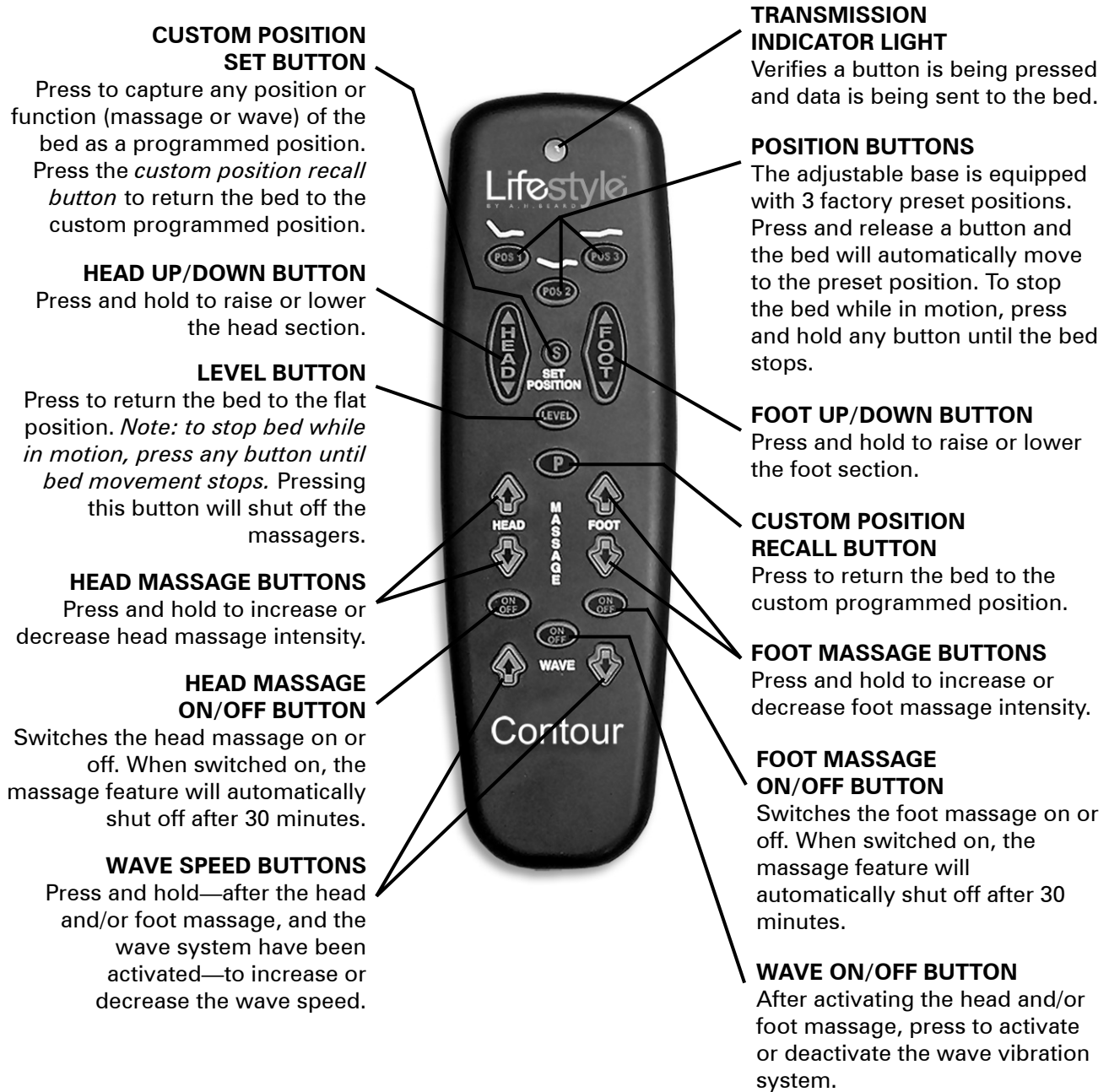

NOTE

HAND CONTROL REQUIRES FOUR (4) AAA SIZE BATTERIES. TO CONSERVE BATTERY LIFE, THE TRANSMITTER TURNS OFF ALL FUNCTIONS WHEN ANY BUTTON IS PRESSED FOR MORE THAN 50 SECONDS.

POWER DOWN BOX OPERATION

In case of a power outage, press and hold the *learn button* on the power down box to lower the bed to the flat position (**FIGURE 1**).

This function is only for lowering the bed and will not operate the bed to any other position. The (2) 9 volt batteries should be replaced after this function is used.

In the event the power down feature does not work, check to make sure the (2) 9 volt batteries are good.

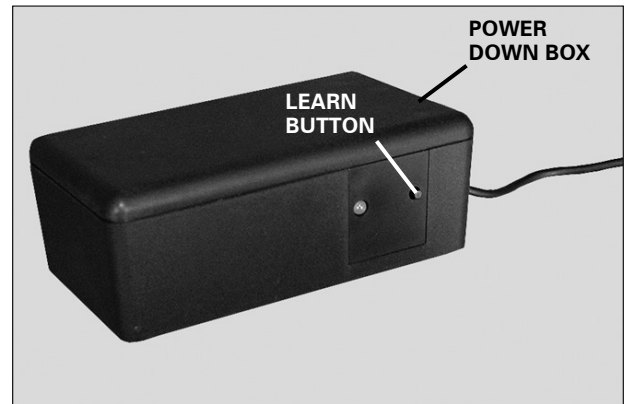

FIGURE 1: Power down box learn button.

CONTOUR PROGRAMMING 1 hand control - 1 bed

The two step procedure below is required to program 1 hand control to operate 1 bed. Before beginning, make certain the bed is plugged into a working grounded electrical outlet. *If programming fails, initiate the programming procedure a second time.*

STEP 1

Locate the receiver unit (power down box) for the bed and press the *learn button* for 1 second and release (**FIGURE 1**).

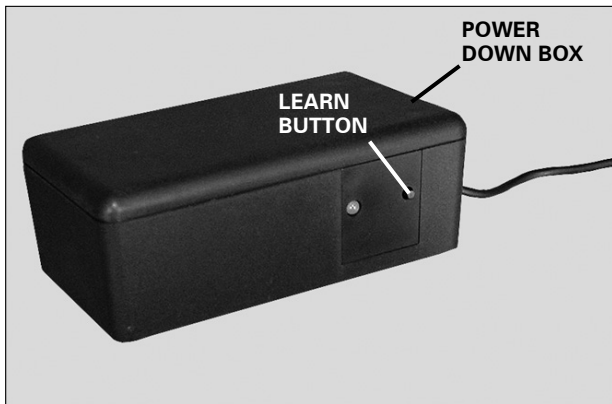

FIGURE 1: Power down box learn button.

STEP 2

On the hand control, simultaneously press and hold the *POS 1* and *head massage on/off* buttons (**FIGURE 2**). The transmission indicator light will flash slowly and then flash rapidly. Continue to hold for 5 seconds and then release the buttons.

One hand control is now programmed to operate one bed.

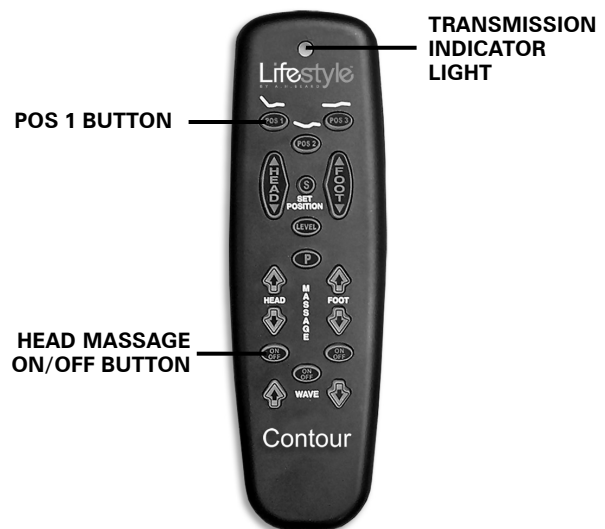
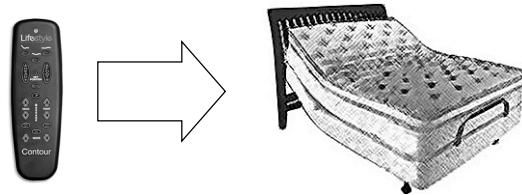

FIGURE 2

CONTOUR PROGRAMMING 2 hand controls - 1 bed

The three step procedure below is required to program 2 hand controls to operate 1 bed. Before beginning, make certain the bed is plugged into a working grounded electrical outlet. *If programming fails, initiate the programming procedure a second time.*

STEP 1

Locate the power down box for the bed and press the *learn button* for 1 second and release (**FIGURE 1**).

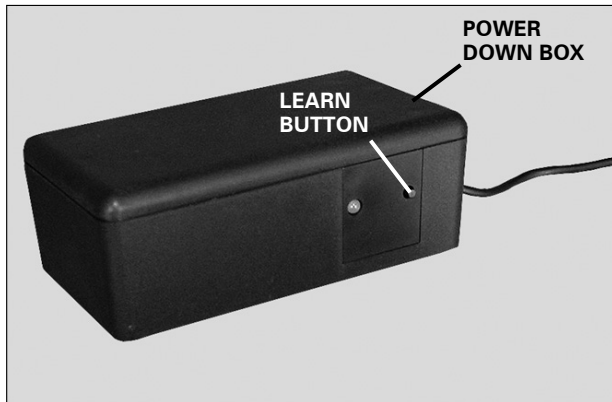

FIGURE 1: Power down box learn button.

STEP 2

On hand control 1, simultaneously press and hold the *POS 1* and *head massage on/off* buttons (**FIGURE 2**). The transmission indicator light will flash slowly and then flash rapidly. Continue to hold for 5 seconds and then release the buttons.

STEP 3

Repeat Step 1 and Step 2 with hand control 2.

Two hand controls are now programmed to operate one bed.

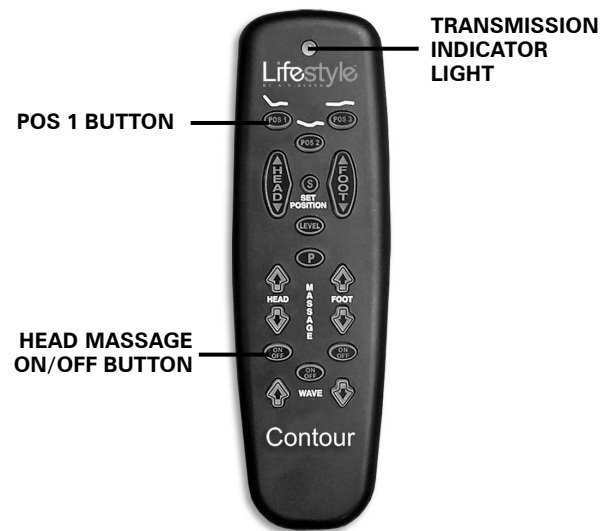
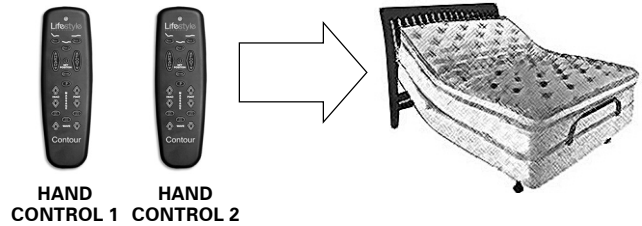

FIGURE 2



NOTE

OPERATE ONLY ONE (1) HAND CONTROL AT A TIME. OPERATING TWO (2) HAND CONTROLS AT THE SAME TIME WILL MOMENTARILY BLOCK BOTH RF SIGNALS AND PREVENT BOTH CONTROLS FROM FUNCTIONING.

CONTOUR PROGRAMMING 1 hand control - 2 beds

The three step procedure below is required to program 1 hand control to operate 2 beds. Before beginning, make certain the beds are plugged into a working grounded electrical outlet. *If programming fails, initiate the programming procedure a second time.*

STEP 1

Locate the power down box for the bed and press the *learn button* for 1 second and release (**FIGURE 1**).

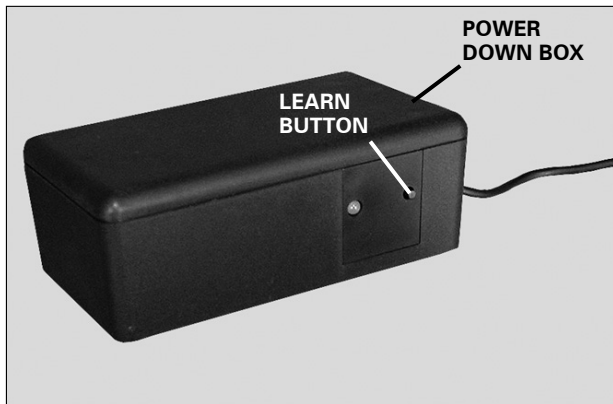

FIGURE 1: Power down box learn button.

STEP 2

On the hand control, simultaneously press and hold the *POS 1* and the *head massage on/off* buttons (**FIGURE 2**). The transmission indicator light will flash slowly and then flash rapidly. Continue to hold for 5 seconds and then release the buttons.

STEP 3

Repeat Step 1 and Step 2 with bed 2.

One hand control is now programmed to operate two beds.

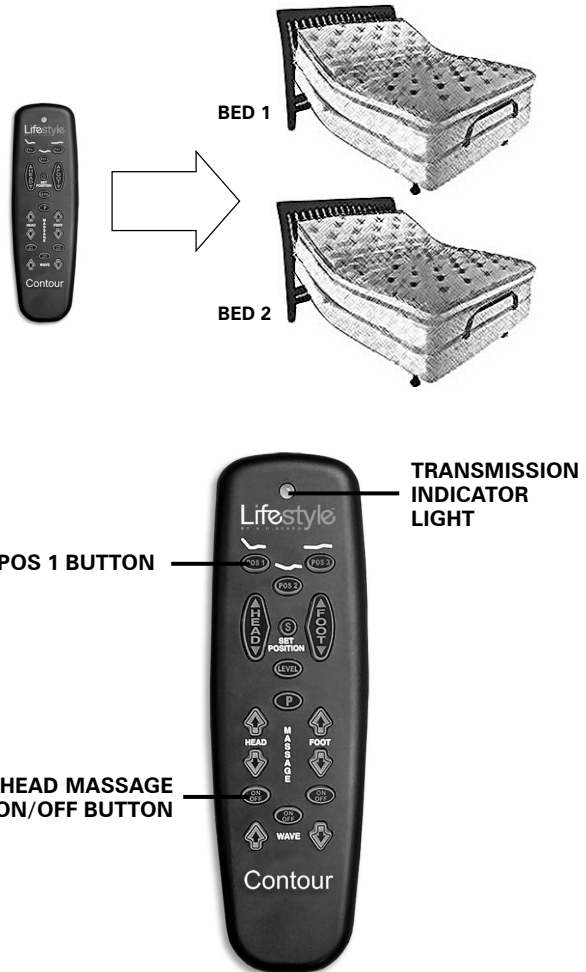

FIGURE 2

CONTOUR PROGRAMMING 2 hand controls - 2 beds

The six step procedure below is required to program 2 hand controls to operate 2 beds. Before beginning, make certain the beds are plugged into a working grounded electrical outlet. *If programming fails, initiate the programming procedure a second time.* **OPERATE ONLY ONE (1) HAND CONTROL AT A TIME. OPERATING TWO (2) HAND CONTROLS AT THE SAME TIME WILL MOMENTARILY BLOCK BOTH RF SIGNALS AND PREVENT BOTH CONTROLS FROM FUNCTIONING.**

STEP 1

Locate the power down box for bed 1 and press the *learn button* for 1 second and release (**FIGURE 1**).

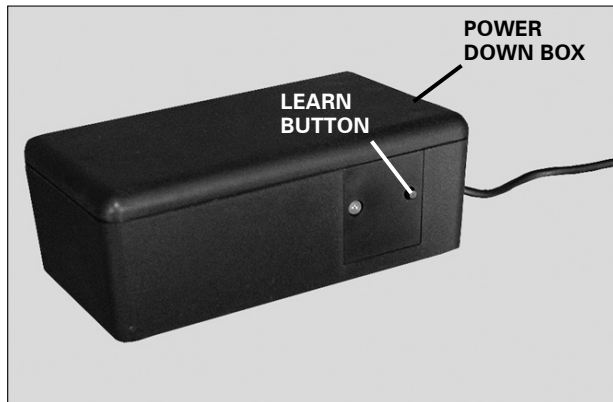

FIGURE 1: Power down box learn button.

STEP 2

On hand control 1, simultaneously press and hold the *POS 1* and the *head massage on/off buttons* (**FIGURE 2**). The transmission indicator light will flash slowly and then flash rapidly. Continue to hold for 5 seconds and then release the buttons.

STEP 3

Repeat Step 1 and Step 2 with hand control 2.

STEP 4

Locate the power down box for bed 2 and press the *learn button* for 1 second and release (**FIGURE 1**).

STEP 5

On hand control 1, simultaneously press and hold the *POS 1* and the *head massage on/off buttons* (**FIGURE 2**). The transmission indicator light will flash slowly and then flash rapidly. Continue to hold for 5 seconds and then release the buttons.

STEP 6

Repeat Step 4 and Step 5 with hand control 2.

Two hand controls are now programmed to operate two beds.

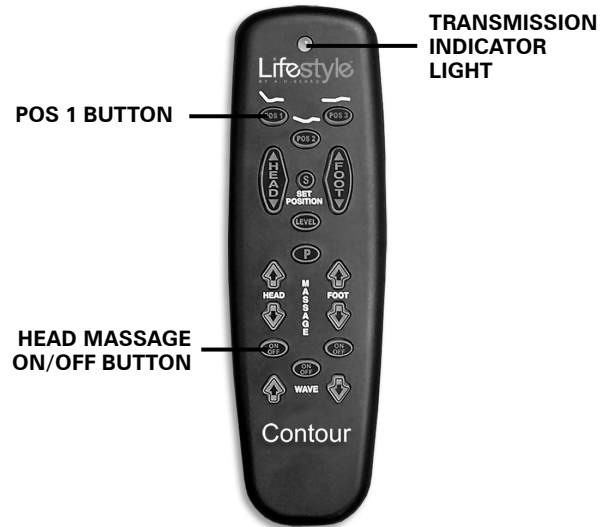
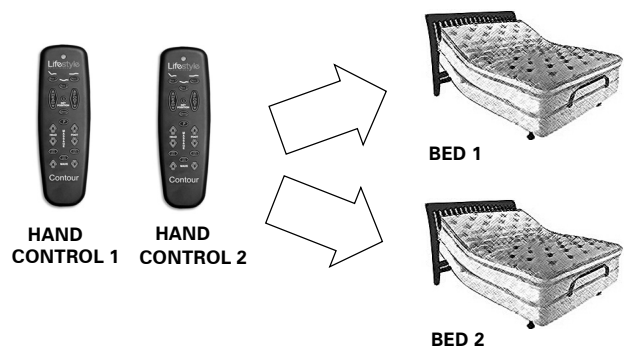

FIGURE 2

CONTOUR REPROGRAMMING *separating 2 beds*

The six step procedure below is required to separate 2 hand controls from operating 2 beds. One hand control per bed operation will result. Before beginning, make certain the beds are plugged into a working grounded electrical outlet. *If programming fails, initiate the programming procedure a second time.* **OPERATE ONLY ONE (1) HAND CONTROL AT A TIME. OPERATING TWO (2) HAND CONTROLS AT THE SAME TIME WILL MOMENTARILY BLOCK BOTH RF SIGNALS AND PREVENT BOTH CONTROLS FROM FUNCTIONING.**

STEP 1

Locate the power down box for bed 1 and press the *learn button* for 1 second and release (**FIGURE 1**).

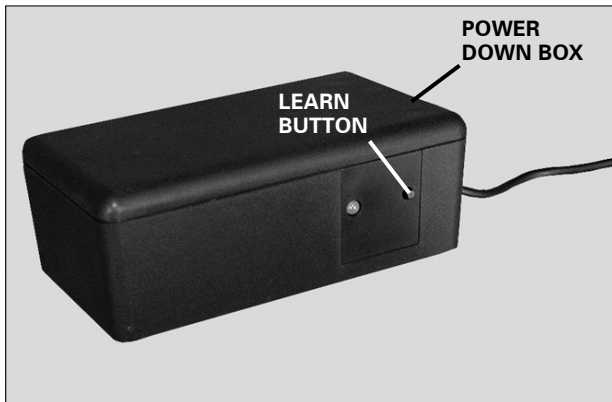

FIGURE 1: Power down box learn button.

STEP 2

On hand control 1, simultaneously press and hold the *POS 1* and the *head massage on/off buttons* (**FIGURE 2**). The transmission indicator light will flash slowly and then flash rapidly. Continue to hold for 5 seconds and then release the buttons.

STEP 3

Repeat Step 1 and Step 2 with hand control 1. **Note: wait 90 seconds before proceeding to Step 4.**

STEP 4

Locate the receiver unit for bed 2 and press the *learn button* for 1 second and release (**FIGURE 1**).

STEP 5

On hand control 2, simultaneously press and hold the *POS 1* and the *head massage on/off buttons* (**FIGURE 2**). The transmission indicator light will flash slowly and then flash rapidly. Continue to hold for 5 seconds and then release the buttons.

STEP 6

Repeat Step 4 and Step 5 with hand control 2.

Independent hand control operation is now restored (hand control 1 operating bed 1; hand control 2 operating bed 2).

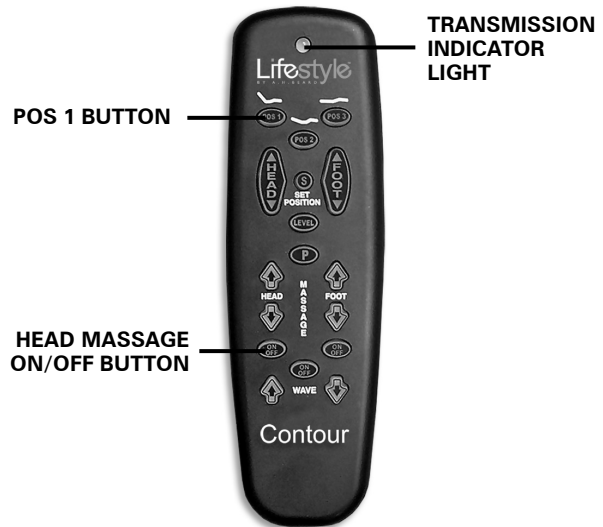
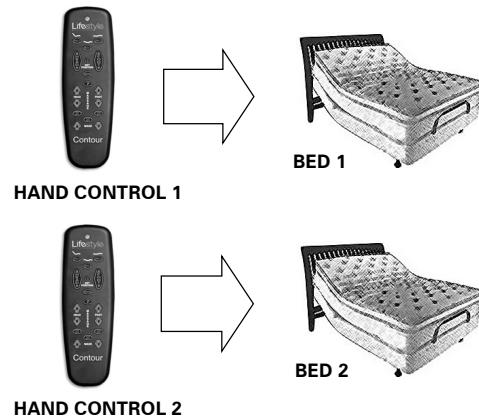

FIGURE 2

Lifestyle
BY A . H . B E A R D ™